





# 1.

1)

- 가 가  
, ,

2)

(1)

- 가 , 가 . 가

(2)

- : 가 , 가 , 가  
✓ ,
- : , 가 , 가  
✓ - ( )  
✓ ( ) - ,

가

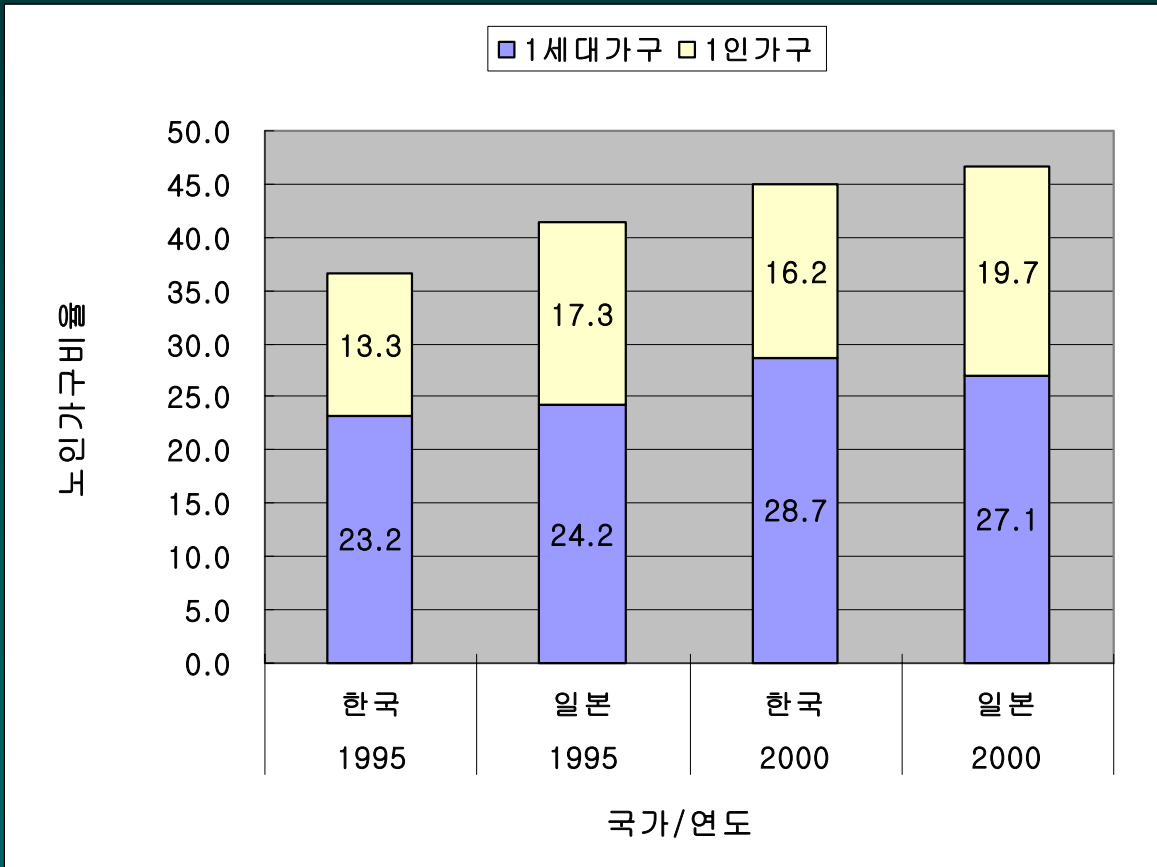

3)

( )

		←-----→		
↑-----↓		Day Service	Day Care	
		Short Stay	Respite Care	

4)

( ,2005)

			,
		,	,
	( )	( ),	,
		( ),	
	( )		
가		,	,
가	가	,	,
			.

# Vs (Knapp's Model)

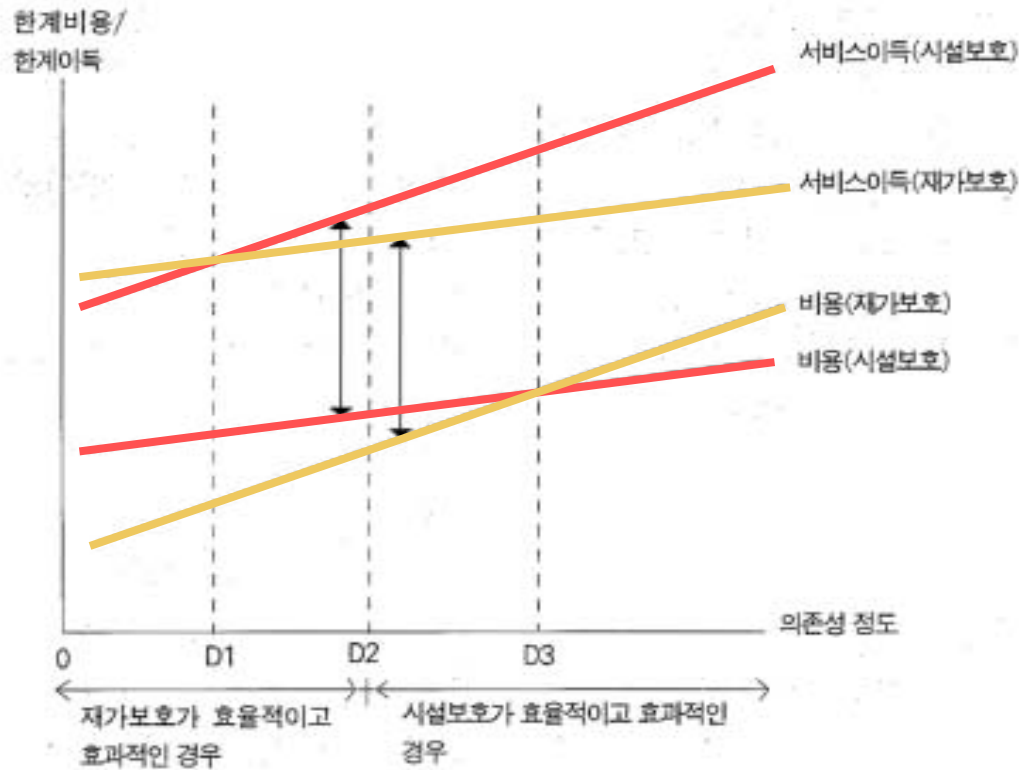

# ■ Hospital Vs Nursing home ?

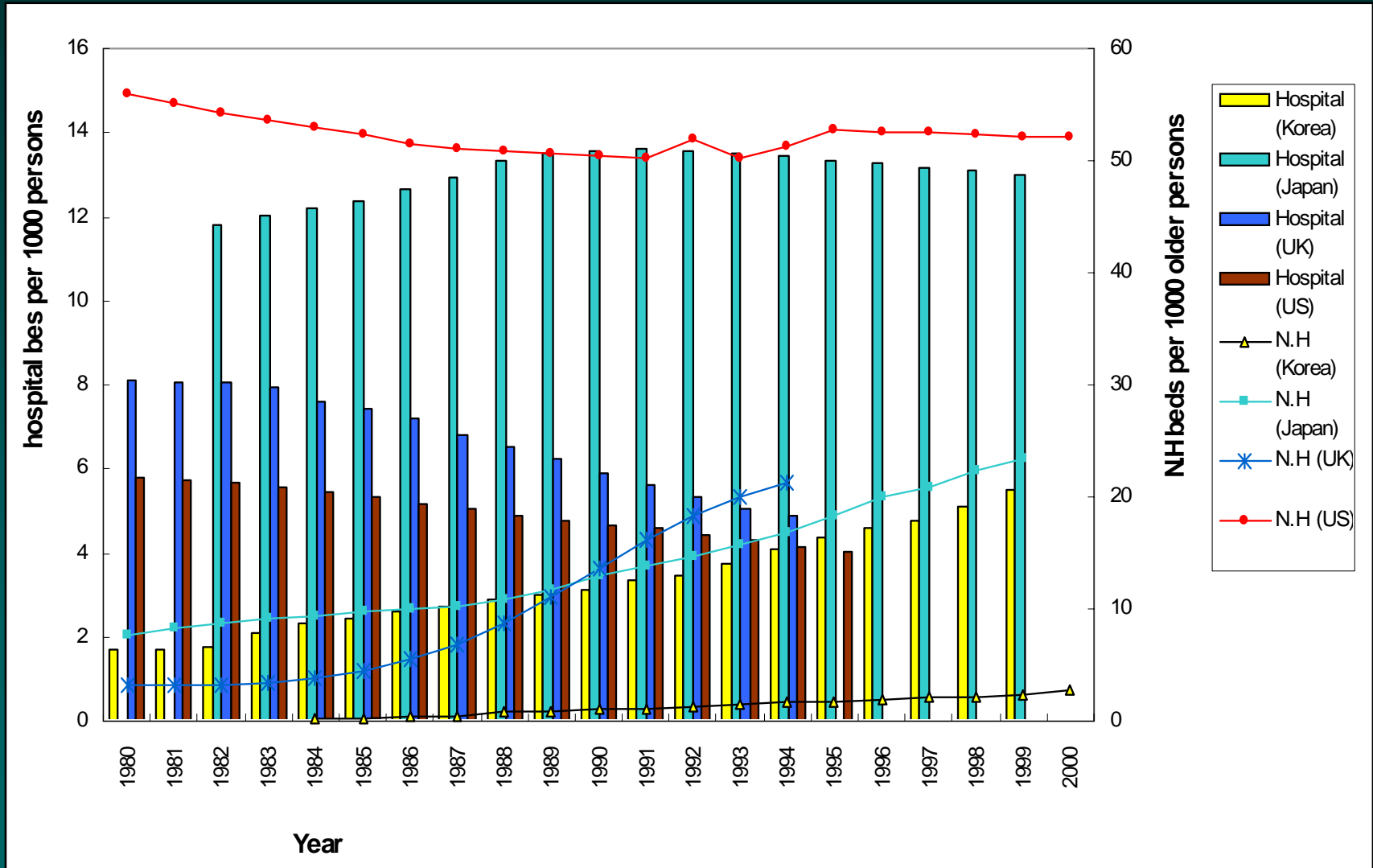





## 2.

1)

- **가** ( , , ) **가** ( , )
- : ( , )
- : ( ),  
Assisted Living Facility, Residential Home
- : ( ), ( ),



		,	,
	Board and Care Home, Assisted Living Facility, CCRC	Nursing Home, CCRC	Geriatric Ward
	Residential Care Home	Nursing Home	Geriatric Ward
	,	,	,

## 2) 가

### (1)

- almshouse (救貧的 )
- 1935 Old Age Pension. 1 ( )
- 1946 Hill Burton .
- 1954 ( ). (1960 2.3%)
- 1965 Medicare, Medicaid가 ( ) 1993 50%
- 1960 ( )
- 1980 Boren Amendment (social service 가 nursing service medicaid)
- - ✓ : (70%), , ,
  - ✓ : 가 , ( ), managed long term care

(2)

- Almshouse( ), hospital( )
- 1834, 1865( ) Poor Law, 가  
( )
- 2 1948 National Assistance Act  
(30-35 ) . NHS  
( )
- 1960 community care .
- 1980 가( )
- 1979  
( )
- 1984 Registered Homes Act가
- 1990 National Health Service and Community Care Act

### (3)

- 1929 救護法( )
- 1946 (戰後) 生活保護法( ) : 救貧的
- 1963 : ( )
- 1983 가 : , ,
- 1986 : ,
- 1992 : .
- 가 . 1992 .
- 1990 ( 10 ) 1994 ( )
- / 가
- 2000 4



(1 가:32% - 2002, , 1 가)

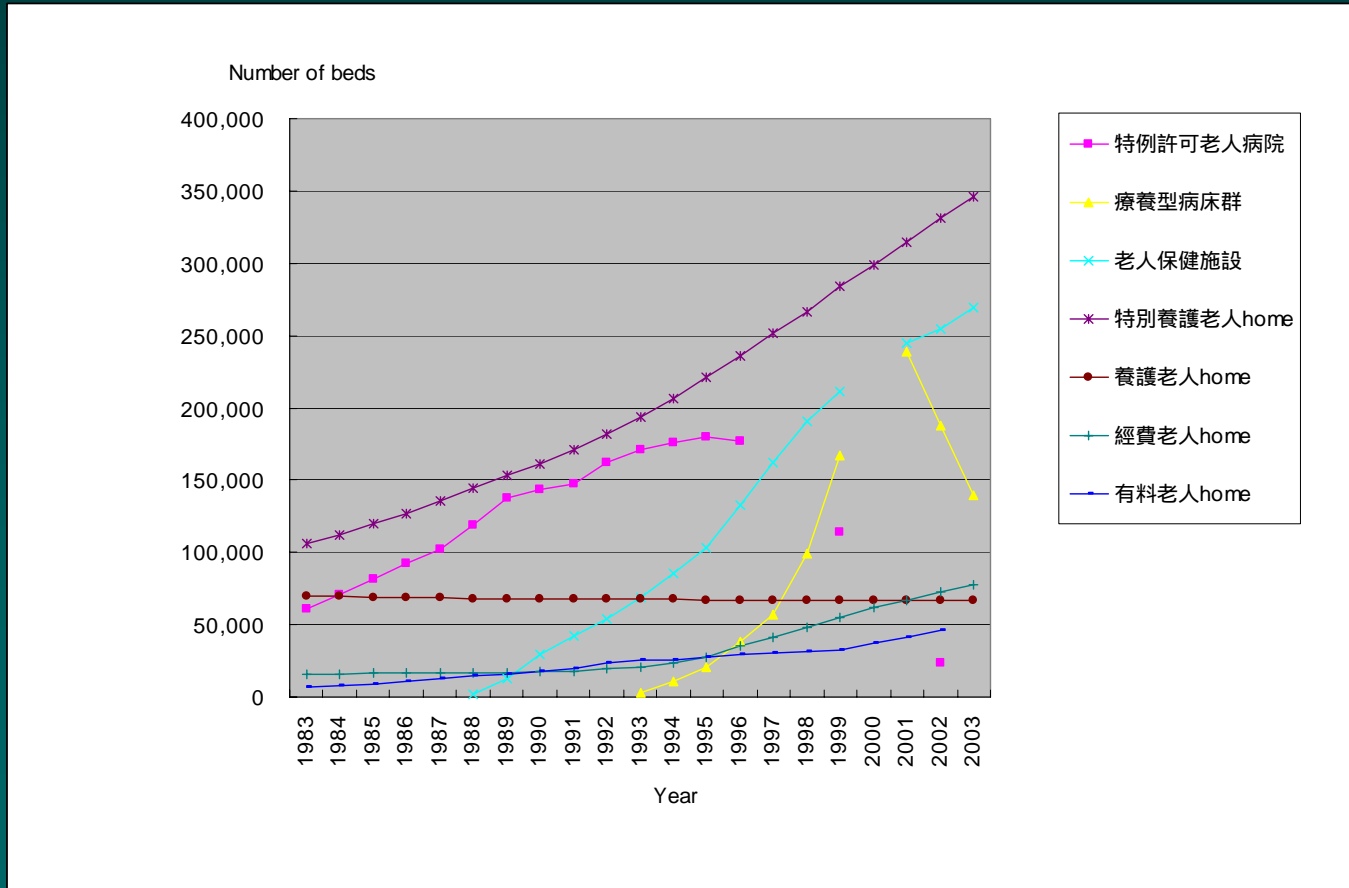

3.

1)

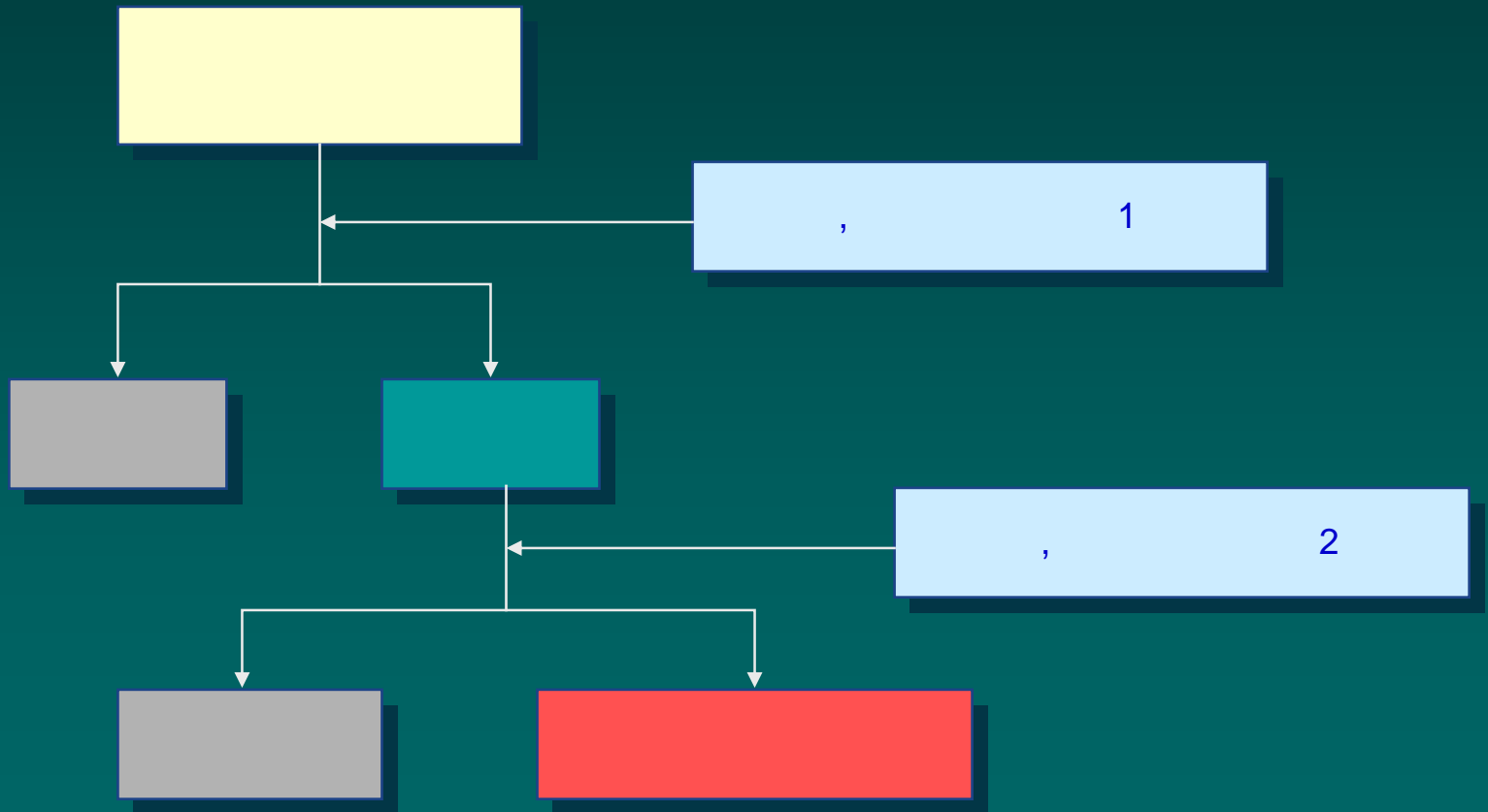



2)

■ 가

- : 75 , , , ,  
1 ,
- : / X 100

■

- (7 ) (13 )
- X1 75 , X2 GDP
- 가

$$Y=0.126X_1 + 0.072 X_2 - 0.396 \quad (R^2=0.99, p=0.0001)$$

3)

(1)

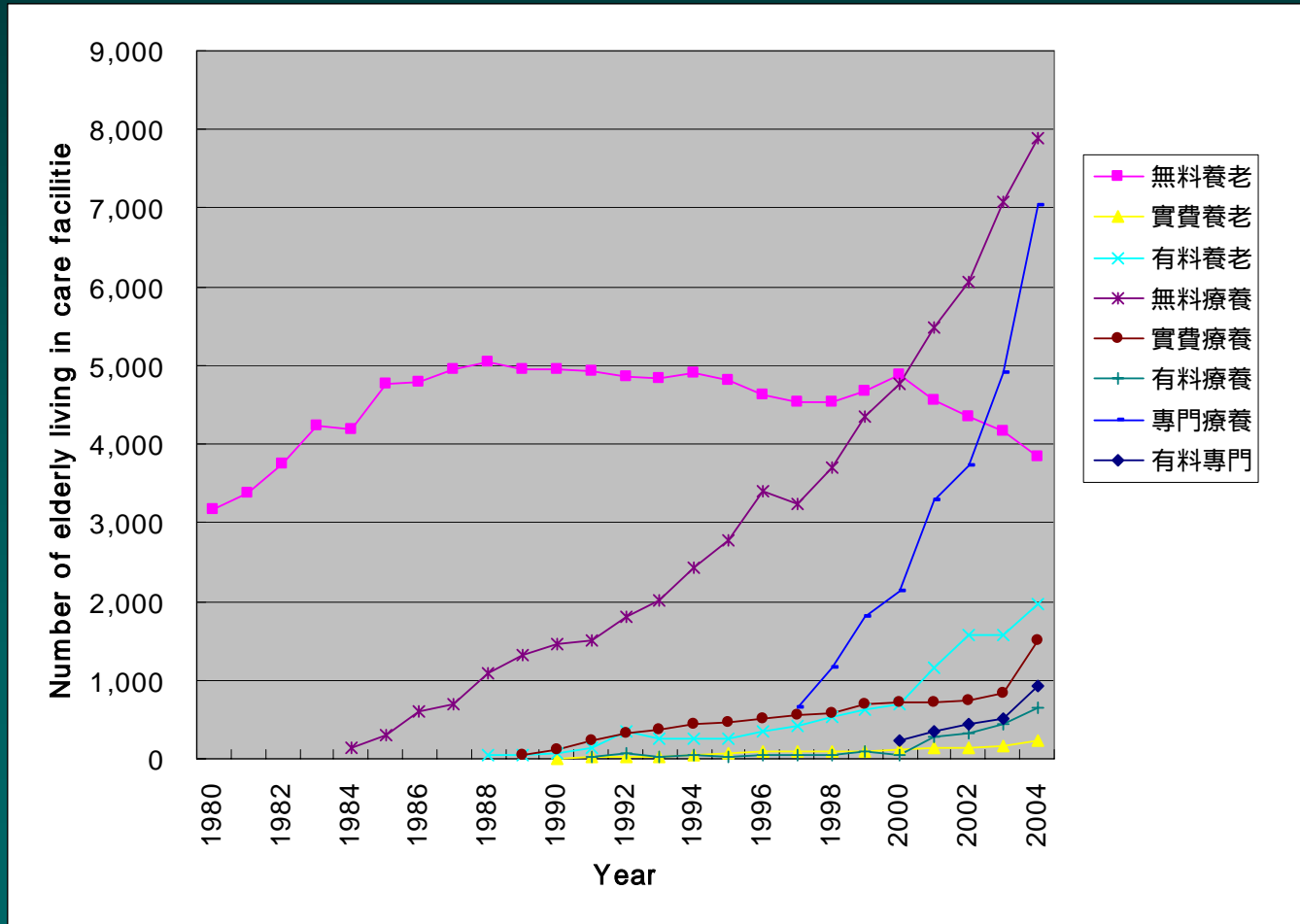

## (2) Trends in proportions of nursing home beds by type

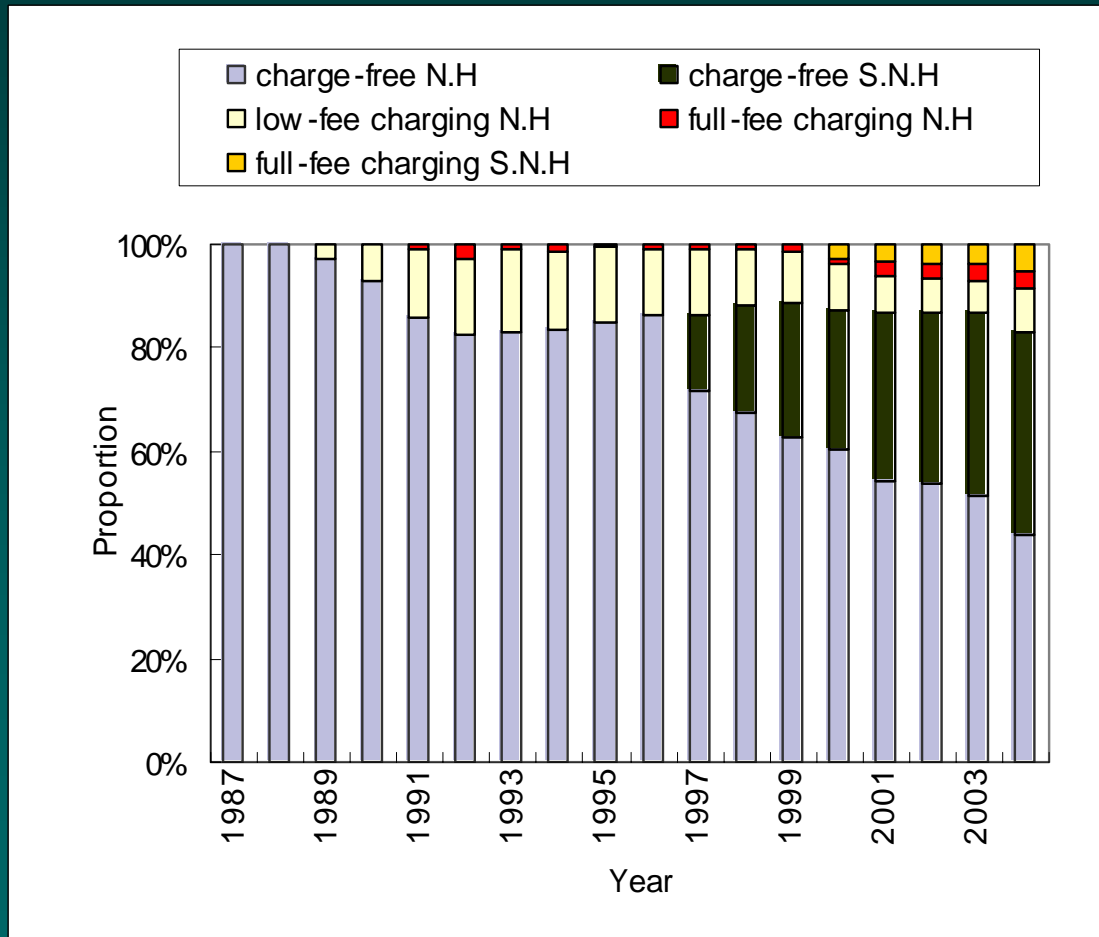

### (3) Supply and occupancy rate of nursing homes by region and type in Korea(%), 2000

Region	Intermediate Nursing Home		Special Nursing Home		Charge- free		Low-fee- charging		Full-fee- charging		Total	
	S.R	O.R	S.R	O.R	S.R	O.R	S.R	O.R	S.R	O.R	S.R	O.R
Metropolitan Area	0.18	91.4	0.13	88.5	0.25	95.3	0.03	77.3	0.03	62.1	0.31	90.2
Rural Area	0.20	81.6	0.06	79.2	0.23	82.6	0.03	74.4	0.01	50.4	0.26	61.7
Whole Country	0.19	84.9	0.08	84.5	0.23	87.5	0.03	75.6	0.02	59.5	0.28	84.8

(4)

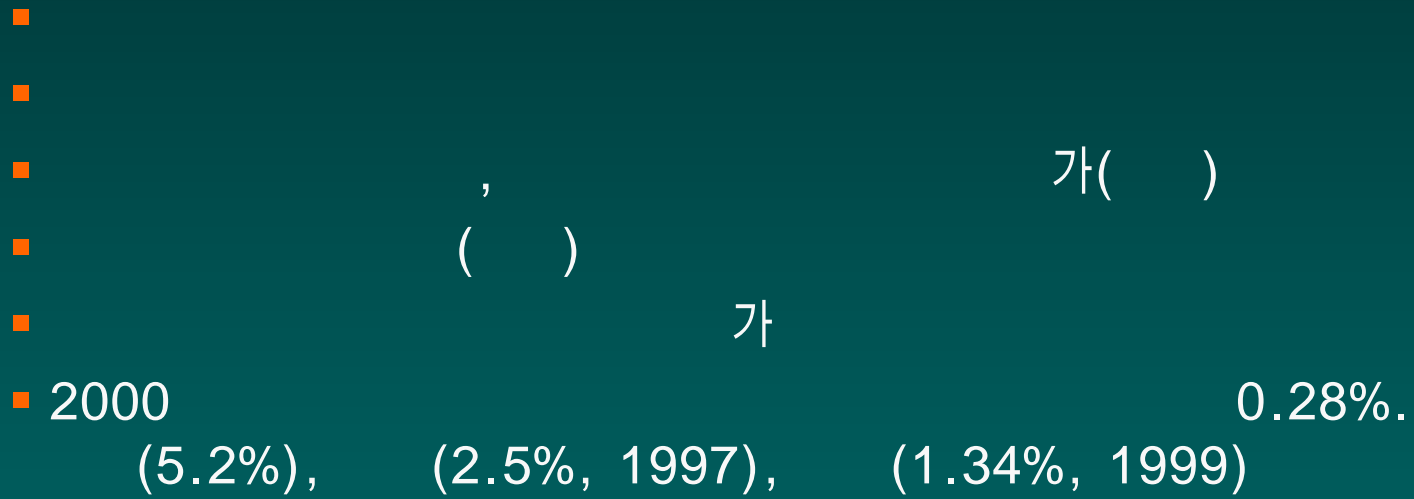

## 4)

### (1) Strategy

- Amount : A lot of nursing homes
- Charging system : Charge-free or Low-fee-charging nursing homes rather than Full-fee-charging ones
- Kinds of nursing home : Special nursing homes rather than intermediate nursing homes
- Location : Urban area rather than rural area(short-term)

# 4.

1)

(1)

- : ( , ) ( , )
- : ( ) ( , )
- 

(2)

- : ( , )
- : ( , )
- , : (universal design)

## 2) Conceptual Framework for Environments for Frail older People

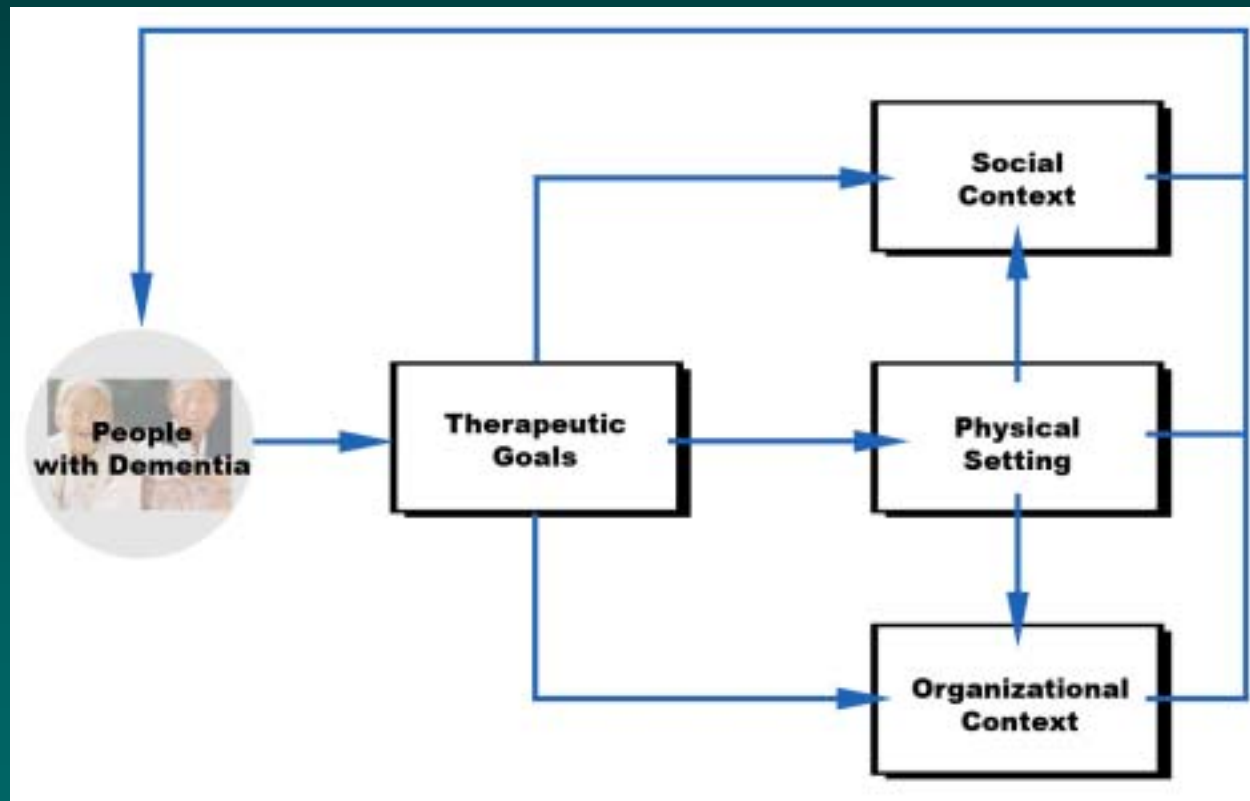



# (1) Therapeutic Goals



(2)

- : 가 , , , , Open Plan, 가  
(Safety)
- : , , , ( )  
(Supportiveness)
- : , , , 가 ,  
(Orientation)
- : ( , , )  
(Stimulation)
- : - , ,  
(Social interaction and Integration)
- : grab bar, , (Negotiability)
- : , ,  
(Flexibility)
- : / .  
(Personalization)

### (3) Lawton and Nahemow's Competence-Press Model

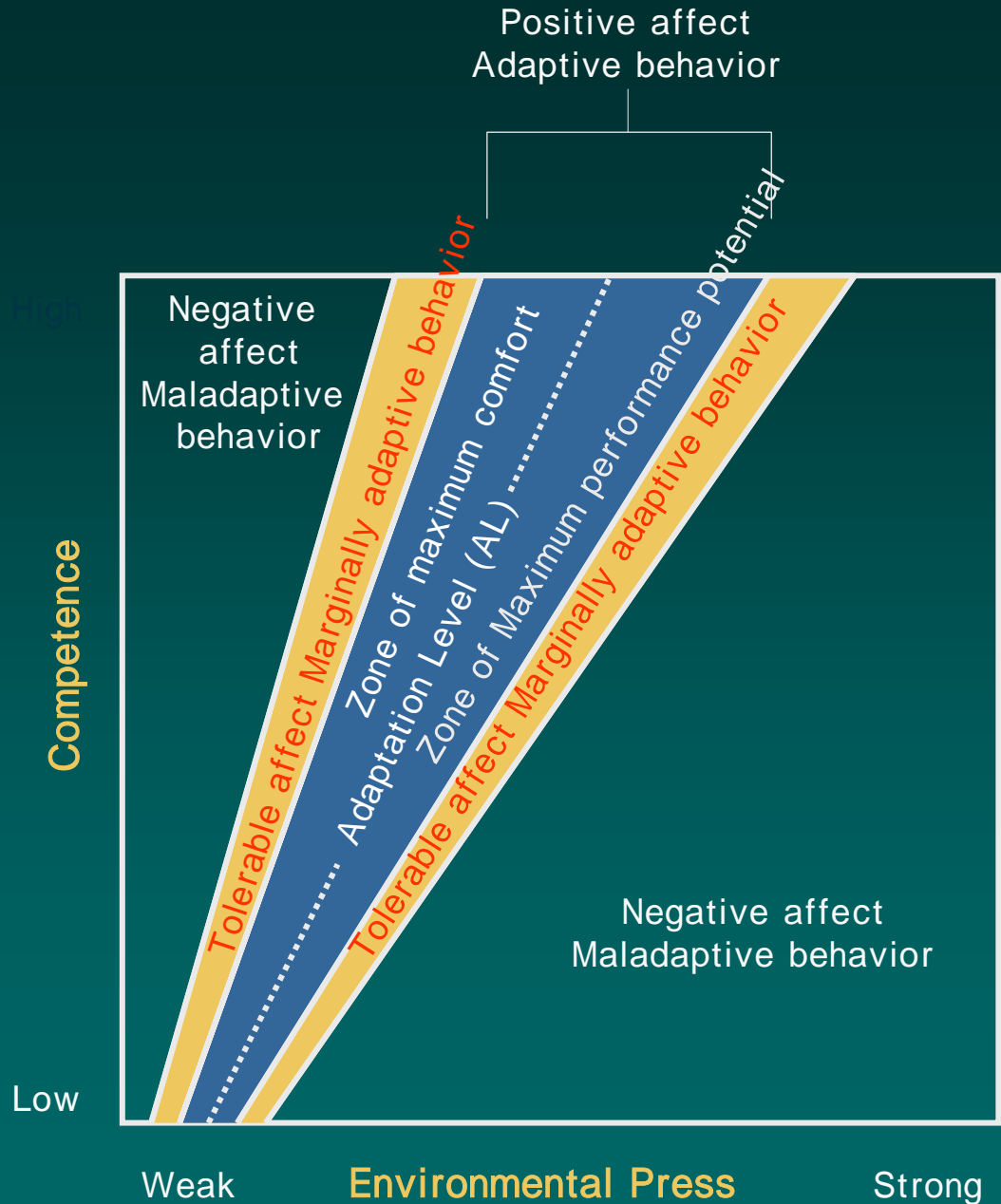

(4)

- 1C, 2C 가
- 
- 
- 3  
(12AB, 12C,  
3ABC)
- 

C	1C	2C	3C
B	1B	2B	3B
A	1A	2A	3A
	1	2	3

3)

(1)

■

✓

✓

✓

■

✓

✓

■

✓ Continuum of Care

✓ Community Care, Aging in Place, Normalization

(2) ( )

■ ( , )

✓ , , : 5 ,

✓ , : 30 ( ) ( )

■

✓

✓

✓

✓ 2005 70 , (2003

) 68

✓ 40 , 100

가  
가 60

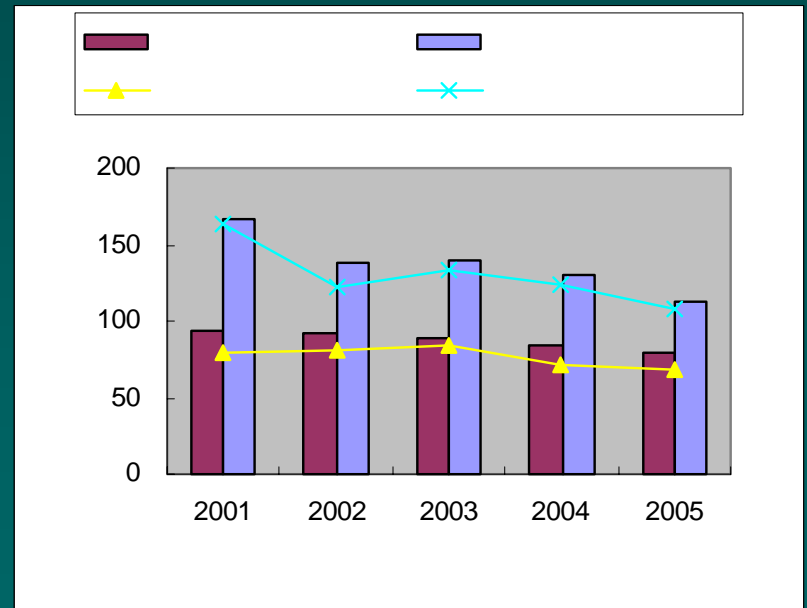

- 1 ( )
- ✓ (2005 , 300 ) ,
- ( , 270 ) 10
- ✓ 1990 16 9
- ✓ , , 45 14
- ✓ 1 11.5 .
- 6.3 ( ) .
- ✓ 6 4 , 1
- 10
- ✓ 2005

1 (m <sup>2</sup> )	15.89 (4.8 )	18.53 (5.6 )	20.955 (6.3 )	15.89 (4.8 )	18.53 (5.6 )

4) ( )

(1)

	( ), , , , , ,
	, , ( ), ,
	, , , , , , , , , ,



(2)

( , )

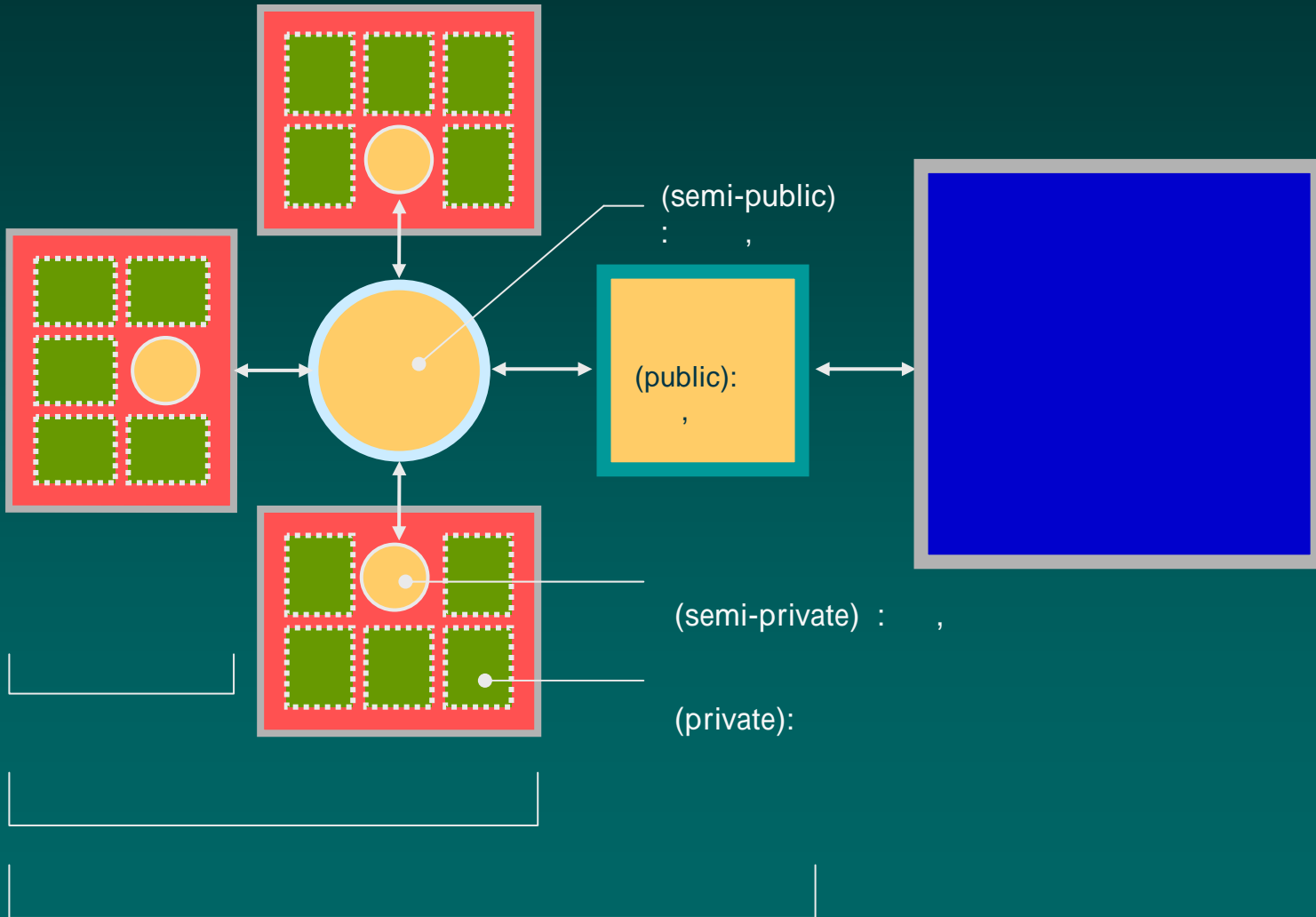

(3)

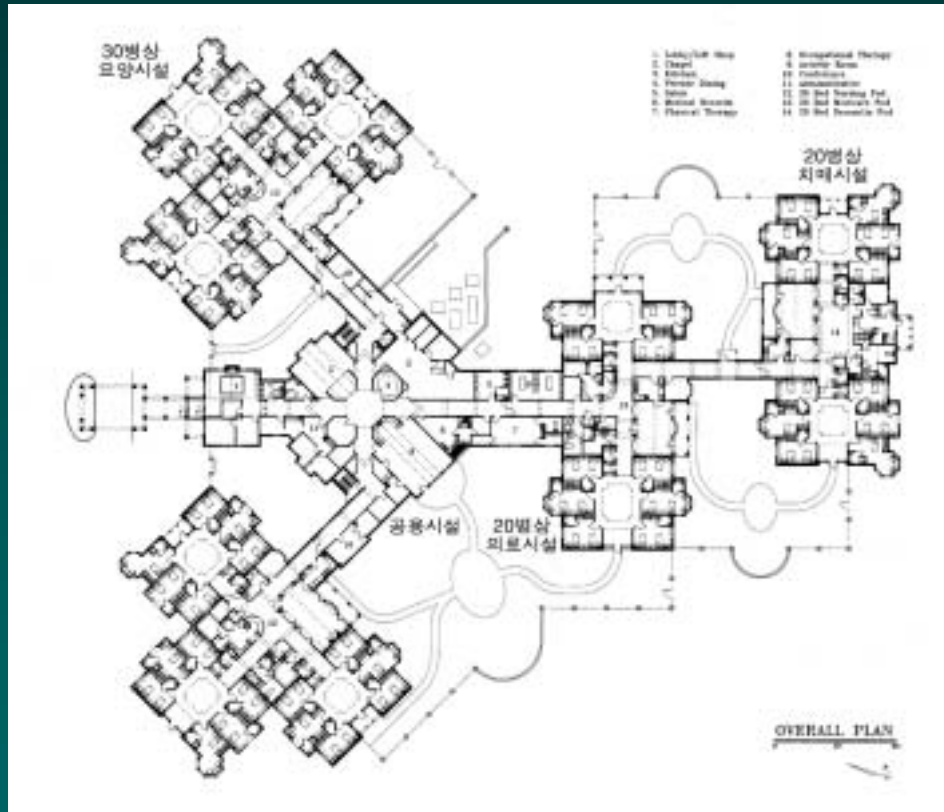

Parkvue Nursing Center



Woodside Place

5)

(1)



( ), , ,



$2/3$



2-4 가 ( 가













, )



가 , ,

가

(2)

	A	B	C	D	
1					AB1, AC1, AD1, BC1, BD1, CD1
2					AB2, AC2, AD2, BC2, BD2, CD2
3					AB3, AC3, AD3, BC3, BD3, CD3

6) ( )

(1) : ,



(2)

- 6
- 4
- 1, 4

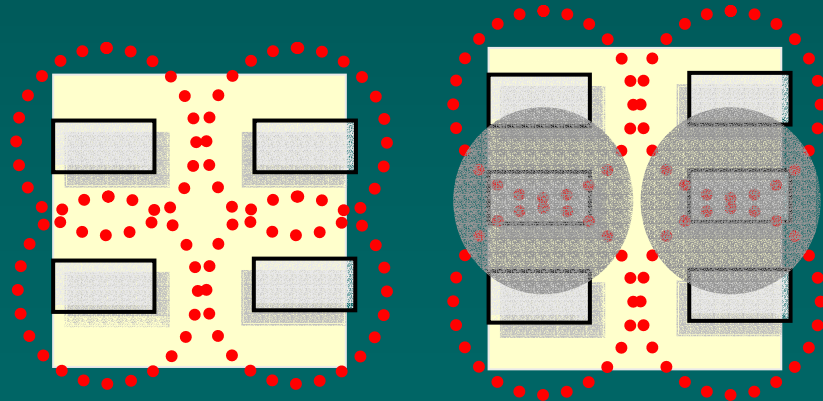



# 5.

1)

## (1) Parkview Nursing Center (Ohio, 1995)

- : United Church Homes, Inc
- : 100 , 1 16beds, 2 84beds. 4
- : 10 beds,
- : 26,700m<sup>2</sup> (8,080 )
- : 5,900m<sup>2</sup> (1,784 ). 17.8

✓  
✓ 30 20 2 ,  
가

✓  
✓ 2-3 .











✓	2000	(Tooting Bec) 1995
✓ 가 (NHS)		
✓ 가 (72%)	(73%)	가
✓ 10 4	, 53%	, ,
✓		5
✓		
✓		
✓		가
✓ 2	가	
✓ ( )		1

### 3)

(1) (1999, )

- :
- : - 80 ( ), 1 40 , 2 40 ( ) /  
通所( ) - 20
- : ( ) 1(1), 10(4), 23(27),  
1(1), 3( 1, 1), 1(1),  
3, 4, 4, ( 2, 2, 1); 50(41  
) ; 1( 1 )(1). ( )
- : , ( , ),
- : 8,858m<sup>2</sup> (2,680 )
- : 3,777m<sup>2</sup> (1,143 , 14.3 ), +
- : , . 1 , 2
- :
- : 2002.2







(2) (2001, )

- : (50), (short stay, 20), (day service), , ,
- : ,
- : 6-7 . 가  
가 12 ,  
17-18 . ( )
- : 3,996 m<sup>2</sup>(1,209 , 17.3 )
- : 4
- : (1 )1014 , 2400 , 1600  
5014 (150,420 / , 1,203,360 / ). 150  
: 120\*20%(24 )+ (30 )+ (20 ) = 74 /
- : , 가





# 4)

## (1)

(2005. 7. )

- : , , 가
- :
- : 250 , 20 , 50
- : 16 ,
- : 9,265m<sup>2</sup> (2,800 , 10.4 ), 1 , 5
- : 142 ( 0.57 , )
- , , -
- ( , 2005 7 )

- ✓ 가
- ✓
- ✓
- ✓

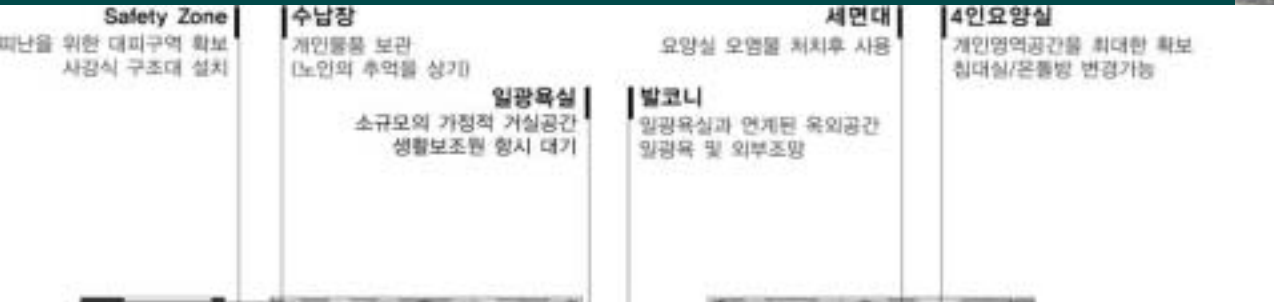
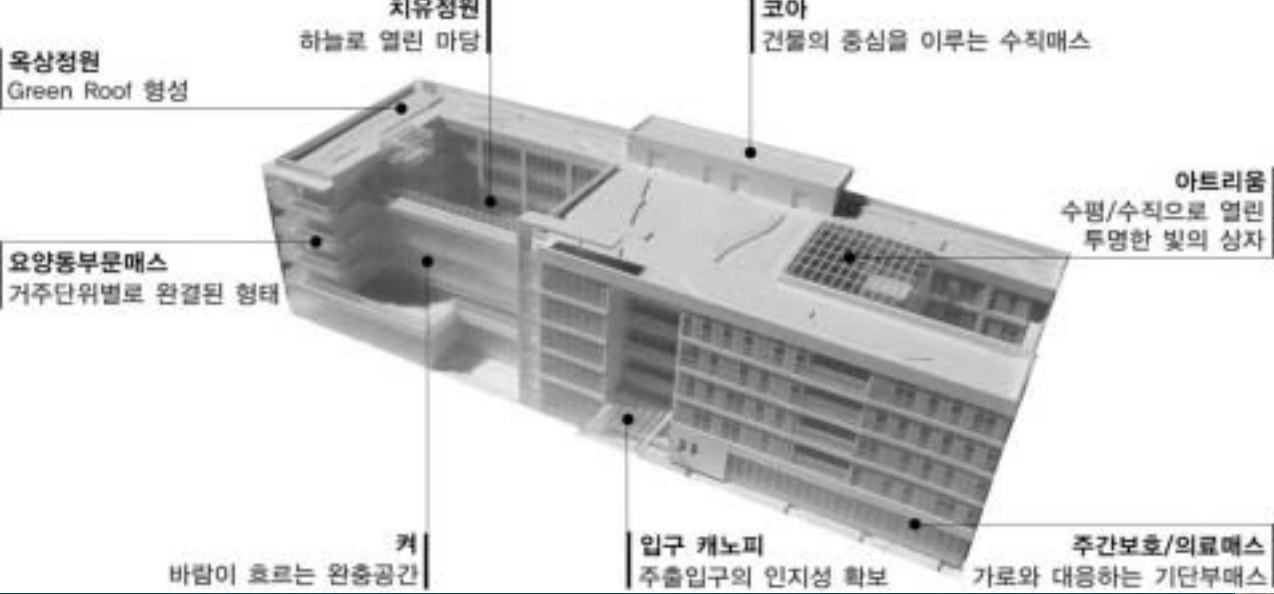

(2) (1995, )

- : ( )
- : 50 , 15-20 . 4
- : 10-15 , ( , )
- : 1,145 m<sup>2</sup>(437 , 8.7 )
- : 4
- : 39 , : 0.65
- : 2005

✓ 가 .  
✓  
✓  
✓  
✓

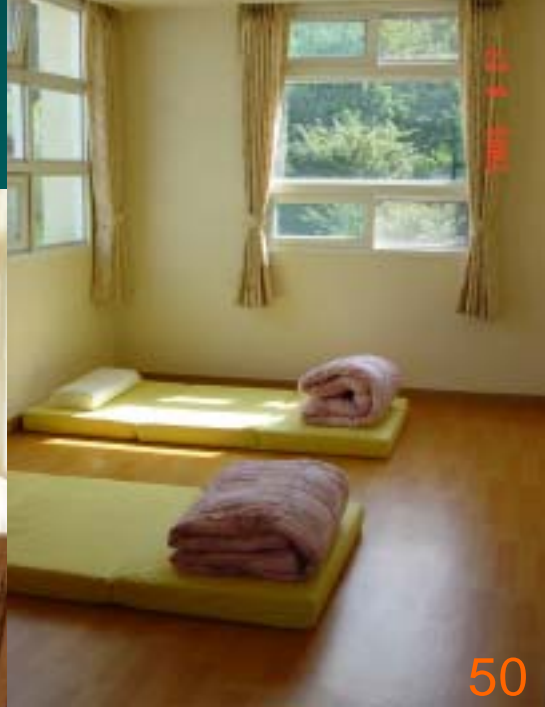



5)



## WoZoCo, 1997, Amsterdam

- 55      100가
- Universal Design
- Open space

13

